

301 West Willow, Harrisburg SD Former Gym Space Available for Lease

VANTIS

COMMERCIAL REAL ESTATE ADVISORS

\$11.50 PSF
NNN



Highlights:

Size: 4125 SF

Lease Terms: NNN
Est \$2.20 PSF

Year Built: 2012

Zoning: Commercial

Property Details:

- Located on Willow near the corner of Cliff Avenue and Willow (Hwy 110)
- Tenants include Harrisburg Family Chiropractic and Prairie Rehabilitation
- Located in the same lot as BP Gas and Convenience Station
- Ready for Gym User
 - 3 tanning rooms
 - Male/Female locker rooms
 - Large open area
 - Reception Desk
- Fantastic location for any retail/office user to include Restaurant, Bar, Boutique, Hair Salon, Real Estate, Insurance or Financial Firm
- Low NNN costs
- Surrounding businesses: New Fareway Grocery Store, Neighborhood Dental, Harrisburg Eye Care, Subway, Allen Homes, Avera Harrisburg Medical Clinic, Casey's General Store, and Remarkable Consignment Shop
- Monument digital signage available for tenants use
- **\$5,000 allowance for carpet/paint**

Amy Ibis, Broker, Associate
605.359.4430
amy@vantiscommercial.com

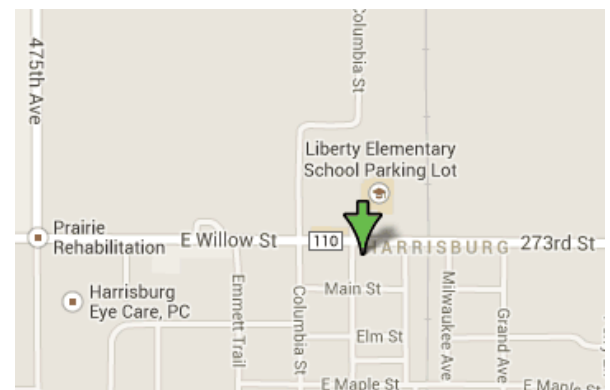

301 West Willow, Harrisburg SD

Former Gym Space Available for Lease

VANTIS

COMMERCIAL REAL ESTATE ADVISORS

\$11.50 PSF
NNN

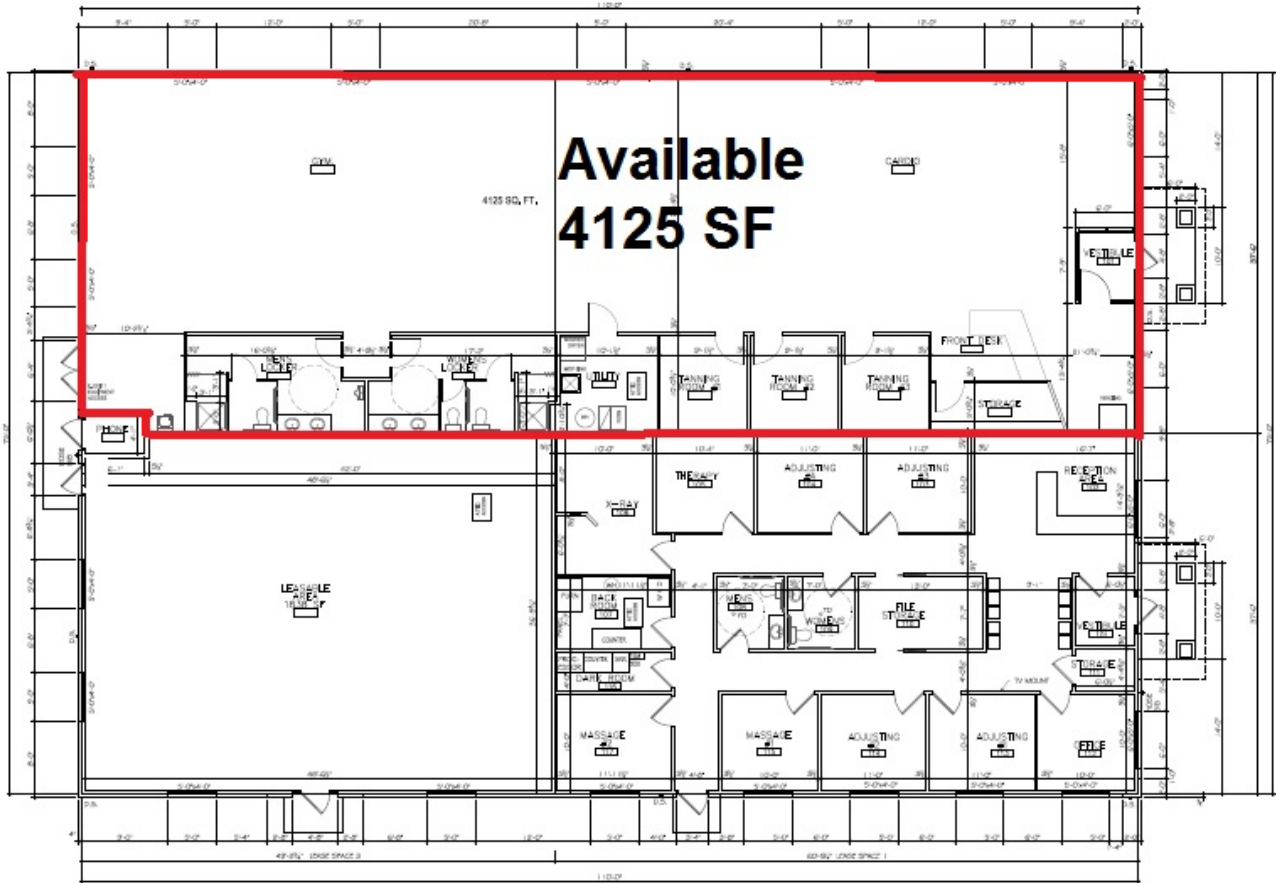

Amy Ibis, Broker, Associate
605.359.4430
amy@vantiscommercial.com

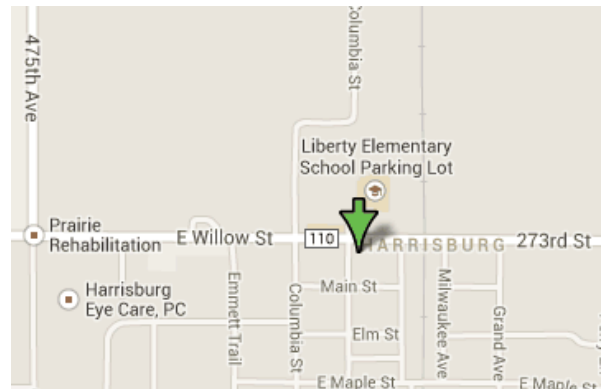

301 West Willow, Harrisburg SD Former Gym Space Available for Lease

VANTIS

COMMERCIAL REAL ESTATE ADVISORS



Amy Ibis, Broker, Associate
605.359.4430
amy@vantiscommercial.com

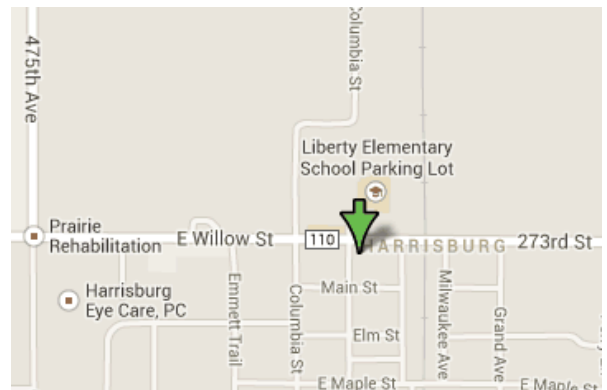

4001 W Valhalla Blvd #206 ● Sioux Falls, SD 57106 ● 605.215.0940 ● www.vantiscommercial.com