

VANTIS

COMMERCIAL REAL ESTATE

6,706 RSF

**Flex Space
for Sublease**

5000 S. MacArthur Lane, Suite 110
Sioux Falls, SD 57108

OFFERING MEMORANDUM

Madison Hulscher
Broker Associate
605.520.6365

madison@vantiscommercial.com

For Lease

For Sublease

5000 S. MacArthur Lane, Suite 110
Sioux Falls, SD 57108

Property Highlights

Size: 5,588 USF
6,706 RSF

Lease Rate: \$15.00 PSF

Terms: NNN

NNN: \$5.00 PSF

Zoned: Commercial

Sublease through July 31, 2028

Property Details

- Space includes reception, five (5) offices, conference, breakroom, and large storage and packaging room
- Common area restrooms
- Underground parking available for rent
- Monument signage available
- Located near the corner of 57th Street and Cliff Avenue
- Co-tenants include Truks-N-Trykes 2, Great Plains Property Management, Progressive Insurance, Expanse Electrical Company, and more
- Area neighbors include HyVee, Burger King, Dominos Pizza, Juice Stop, Dacotah Bank, Get N' Go, Walgreens, and many more retail, restaurants, and residential rooftops



VANTIS

Madison Hulscher
Broker Associate
605.520.6365
madison@vantiscommercial.com

Floor Plan

For Sublease

5000 S. MacArthur Lane, Suite 110
Sioux Falls, SD 57108

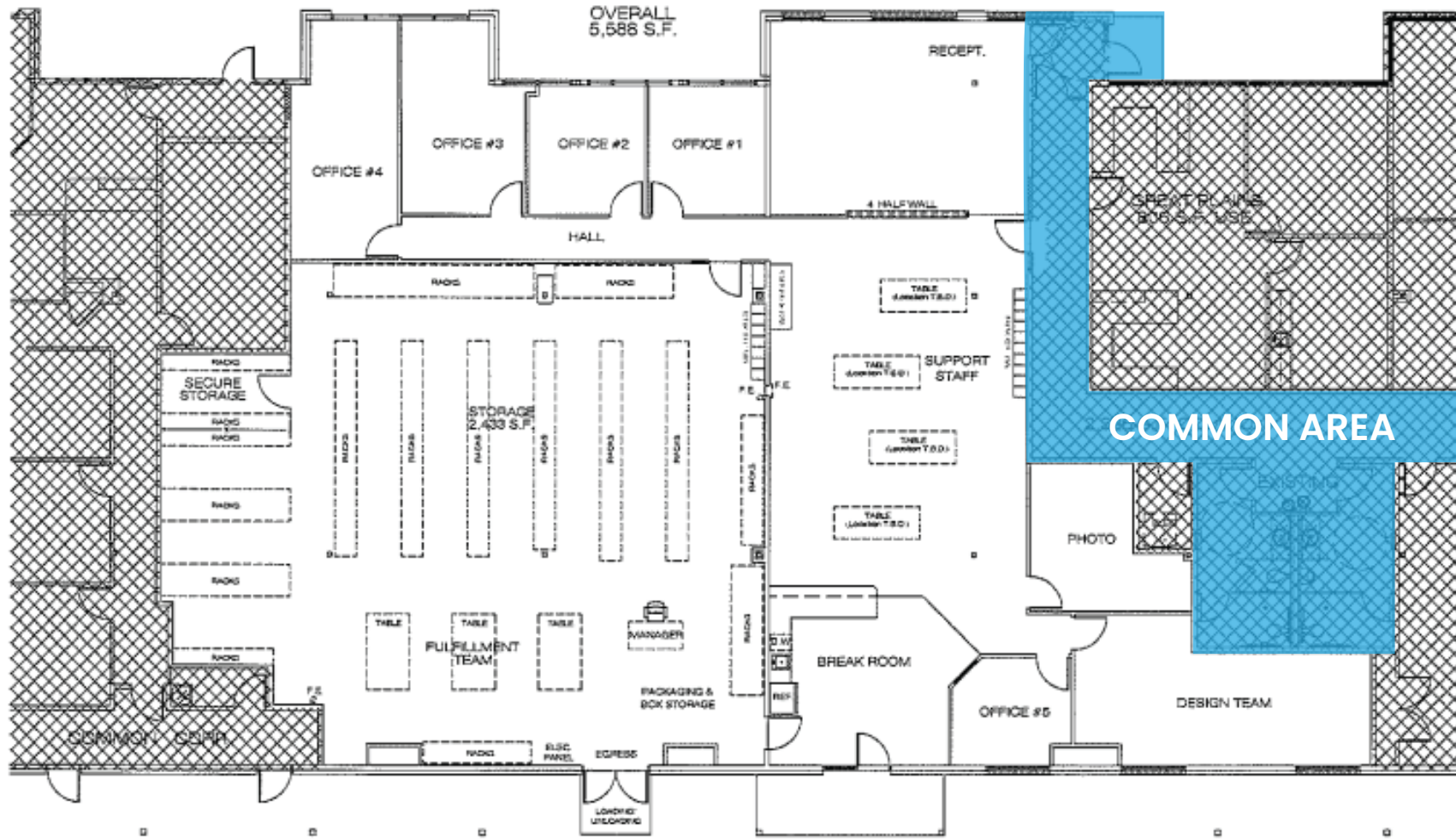

Madison Hulscher
Broker Associate
605.520.6365
madison@vantiscommercial.com

Aerial Photo

For Sublease

5000 S. MacArthur Lane, Suite 110
Sioux Falls, SD 57108



Madison Hulscher
Broker Associate
605.520.6365
madison@vantiscommercial.com

Market Overview Map

For Sublease

5000 S. MacArthur Lane, Suite 110, Sioux Falls, SD 57108



Madison Hulscher
Broker Associate
605.520.6365
madison@vantiscommercial.com